

Ex i ... 8 V DC limit switch box with membrane vent for zone 1, 2 or 22, 22 for pneumatic actuators

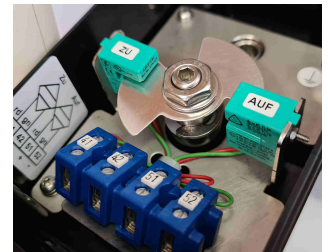
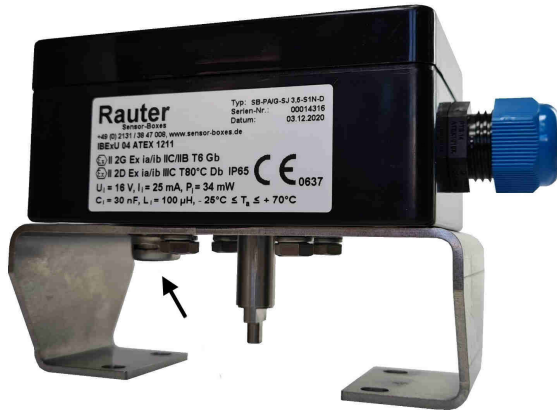

The membrane vent prevents the origin of subpressure in the housing with quick climate changes. Therefore is able outside from none moisture or water about the housing sealing are drawn

technical data limit switch box

ATEX identification	II 2G Ex ia/ib IIC/IIB T6 Gb II 2D Ex ia/ib IIIC T 80 °C Db
ambient temperature range	- 25 °C ≤ T _a ≤ + 70 °C
protection class	IP 65
material housing	PA = polyamide black, R _o ≤ 10 ⁹ Ω, RAL 9005
dimensions housing	120x80x55 mm
cable gland	M20x1,5 mm clamp range Ø 11-9,5 mm, Ø 9-7 mm, Ø 7-5,5 mm, polyamide
mini-terminals	2x 2-pole, maximum 2,5 mm ²
membrane vent	M12x1,5 mm, stainless steel
weight with/without stainless steel bracket	0,6 kg/0,3 kg
options	closed cover or cover with transparent window
bracket connection	F05 slot
actuator connection	acc. to VDI/VDE 3845, steam high: 20, 30 and 50 mm, hole spacing 80x30 mm and 130x30 mm

technical data limit switches

Pepperl+Fuchs sensor types:	1) SJ 3,5-N 2) SC 3,5-NO 3) NJ2-12GK-N 4) SJ 3,5-SN, NJ2-12GK-SN 5) SJ 3,5-S1N
nominal voltage	8 V DC
nominal current 1)-4)	detected ≤ 1mA / undetected ≥ 3mA
nominal current 5)	detected ≥ 3mA / undetected ≤ 1mA
switching function	0° + 90°, 0° + 180° or adjustable
output wire	2-wire 1)-5)
switching function	NC 1)-4), NO 5)
output polarity	NAMUR 1)-3) safety function 4)-5)
acc. to IEC 61508	usable up to SIL2 1)-3), SIL3 4)-5)

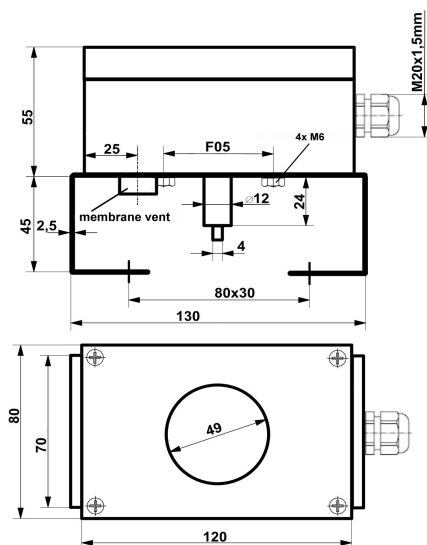

dimensions

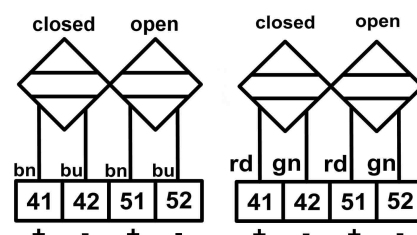

wiring diagrams: left general, right SJ 3,5-S1N